



SOUTH TAMPA FELLOWSHIP

CONNECTION

AND GROWTH

SPRING 2012



We are excited about how God has worked in our lives in 2011 and are looking forward to 2012! Our prayer for you is that you know and love God more in 2012, as He works in each of us to transform our lives to be like Jesus (Galatians 4:19), and as He invites us to play a role in the story He is writing for His glory in lives around the world.

God's design is that our growth as believers is significantly accelerated when we live and learn in the context of community. He has designed the body to grow and work when we are closely connected to one another (Ephesians 4:16, Hebrews 10:25).

It can be liberating and life-infusing to be in a community where we know others deeply, are deeply known ourselves and where we seek intimacy with Christ and serve Him together.

This new year, we are offering a number of ways you can do that. There will be a number of short-term groups (called Growth Groups) that cluster around a particular subject or topic of study for a certain number of weeks, ending before the summer starts. There will be other, longer-term groups (Small Groups) focusing on relationships, growth and missional living, which are intended to last two semesters or possibly longer, taking you through the end of 2012.

There are Bible studies on Sunday mornings, groups on Wednesday nights, and a variety of other options.

Please take some time to ask God where He would have you connect and grow with others this new year. Although we want you to be cautious about over-committing yourself, we do want you to get yourself into an optimal environment in which you can both experience Jesus and learn from God's Word in the company of fellow travelers on this road of discipleship.

From January 8-29, you will have an opportunity to sign up for groups and classes, which begin February 5 or after. You can sign up either in the atrium on Sundays or online at www.stfchurch.com.

Also, there will be a Connection Fair at the BP Campus on Sunday, January 15, and at the Islands Campus on Sunday, January 22, following the services. During that time, you can meet leaders and learn more details about the groups, in addition to the information contained in this brochure.

Plug in. Get connected. Invest your life in loving God, loving others and living on mission for Christ!

Table of Contents

Sunday Mornings on Campus.....	2
Ballast Point Campus.....	2
Adult Bible Studies (ABS).....	2
Semester Growth Groups.....	3
Davis Islands Campus.....	4
Semester Growth Groups.....	4
Monthly Potluck Lunch.....	4
Wednesday Evenings at Ballast Point.....	5
Adult Connection & Growth Opportunities.....	6
Opportunities by Day of the Week.....	6
Getting Started.....	8
Starting Point.....	8
Shoreline Membership Class.....	8
Small Groups.....	9
Mixed.....	9
Neighborhood Gatherings.....	10
Men.....	10
Women.....	10
Semester Growth Groups.....	12
Foundations.....	12
Missional/Serving.....	12
Wise Living.....	12
Men.....	13
Women.....	13
Marrieds.....	14
Parents.....	14
Healing and Growth.....	15
Celebrate Recovery.....	15
DivorceCare and DivorceCare for Kids.....	16
GriefShare.....	16
Life-Stage Opportunities and Gatherings.....	17
Senior Adults.....	17
Single Adults.....	17
Students and Children.....	18
EPIC Student Ministry: Middle and High School Students.....	18
Children's Ministry.....	20
Appendix.....	21
Ballast Point Campus Map.....	21
STF Policy for Child Care in Groups.....	22



Sunday Mornings on Campus

Below are Connecting & Growth opportunities on campus, before and after various worship services.

Ballast Point Campus

See map in Appendix for locations of rooms.

Adult Bible Studies (ABS)

All ABS classes gladly welcome visitors. No sign-up is needed. You may begin attending at any time. Contact Jim Weeks at Jim@stfchurch.com with any questions. *No classes are currently offered during the 8 AM BP worship service.*

9:30-10:45 AM

Young Marrieds, Room A202

Led by David and Robyn Ebacher

Beginning this semester this class will be using curriculum from Barbara and Dennis Rainey on biblical communication in marriage. Whether you are recently married or have been married for years, you and your spouse are welcome to join us as we walk through this study together and learn how to communicate more effectively with one another in Christ.

Emmaus Road, Room A218 (Choir Rehearsal Room)

Led by Russ Peavyhouse

This is primarily a senior adults' class, but everyone is welcome to attend. They are studying the Gospel of Mark.

Crossroads, Room B212

Led by Mike McCraw

All ages are welcome, but the class has a primary focus on singles over 35. Crossroads will be continuing their study of the entire Bible through curriculum called "The Story," an informative and entertaining walk through God's Word with an emphasis on God's work through people and human history. Each lesson stands alone, so you can join at any time!

Joy, Room B209

Led by Bill Johnston

This is primarily a senior adult class, but everyone is welcome. They studying the Book of Acts and then will move into Romans.

Banias, Room A200

Led by Ken and Becky Coppedge

All ages and life stages are welcome, but those currently attending are primarily married couples and some singles over 50. They are doing a verse-by-verse study through Acts.

11:00-12:15

Mosaic, Room A201

Led by Jim & Susan Weeks and Thomas & Denise Dickerhoof

This class is open to all ages, and to marrieds and singles – a few high school students even attend. The class is a theologically-focused session for advanced Bible students. This semester they will be studying the life of David, followed by an intensive, verse-by-verse look at the minor prophet Zechariah



The Good Race, Room A202

Led by Randy Sheets

This class is primarily directed at married couples between 30 and 50, but people of all ages and stages of life are welcome. This semester the Good Race will take a verse-by-verse walk through Daniel, with a special focus on Daniel's end-times prophecies in chapter 9. This is an in-depth class with lively discussion.

Growing in Grace, Room B208

Led by Cindy Alexander

This class for women of all ages will begin a new study in mid-February.

Semester Growth Groups

Growth Groups are different than ABS classes in that they are for a set number of weeks, targeted on a focused topic and curriculum, and require sign ups. See page 12 for a description of Growth Groups.

9:30-10:45

Child Dedication Class

Sundays for 3 weeks, Room D100, beginning February 5

See description on page 14.

Premarital: Saving Your Marriage Before It Starts, by Les & Leslie Parrott

Sundays for 8 weeks, Room B207, beginning March 25

See description on page 14.

11:00-12:15

Marrieds: I Love You More: How Everyday Problems Can Strengthen Your Marriage, by Les & Leslie Parrott

Sundays for 6 weeks, Room B207, beginning February 19

Led by Mike and Jodi Merritt

See description on page 14.



Davis Islands Campus

Semester Growth Groups

See description of what a Growth Group is on page 12.

Starting Point

Sundays, 9:30-10:45 AM, start date to be announced, Room 132

See description on page 8.

Resolving Everyday Conflict, by Ken Sande and Kevin Johnson

Sundays, 9:30-10:45AM, beginning February 5, Room 131

Led by John & Shelby Hladon and Doug & Tabitha Free

See description on page 12.

Monthly Potluck Lunch

Typically the “Second Sunday” of the month following the service, gather together for a potluck lunch in the game room! Bring your favorite dish or dessert, and drop it off in the kitchen before service.

Wednesday Evenings at Ballast Point

Growth Opportunities

We have a lot going on at the Ballast Point Campus on Wednesday nights, and there are growth opportunities for all ages!

See the map in the Appendix for room locations.

For the kids, Awana continues. Find out more about Awana on page 20.

For middle and high school students, find out more about these opportunities on page 18.

For adults, we have several offerings to choose from.

- The Book of Ruth, verse-by-verse study, led by Pastor Craig in the East Worship Center
- Spanish-speaking church led by Angel and Karen Oyola, in room A201
- Starting Point, led by Jose and Christina DeJesus, in room B208. Details on page 8.
- Parenting group, led by Scott and Beth Wiggins, in room A200. Details on page 14.
- Single moms' group, led by Catie Whelan, in room B207. Details on page 11.
- Wives' group, led by Lisa Graybill, in room A202. Details on page 13.
- Shoreline Membership Class, in room A201. Details on page 8.

Dinner

Join us before the service and Wednesday night activities for a great meal in the West Worship Center (Fellowship Hall). Entrees are just \$6 and include two sides. Call 251-1515, ext. 402, on Wednesday each week for that night's full menu. Dinner service runs from 4:30 to 6 PM.

IMPORTANT NOTE: At 6 PM, dividers will be placed in the West Worship Center to prepare for Awana, which will begin at 6:05 PM. After that time, we ask that you enjoy your meal in the café or at the tables in the atrium.

Adult Connection & Growth Opportunities

Opportunities by Day of the Week

SUNDAY		MONDAY		TUESDAY	
	We have Adult Bible Studies (ABS) available at the Ballast Point Campus. (p. 2-3)	6 – 7:30 PM	Small Group (p. 9) Brandon 1 st and 3 rd Mondays	9:30 – 11:30 AM	Daniel: Lives of Integrity, Words of Prophecy (p. 13) Women's Bible Study Ballast Point Campus
9:30 – 10:45 AM	Child Dedication Class (p.14) Ballast Point Campus <i>Feb 5, 12 and 19</i>	7 PM	Small Group (p. 9) North Tampa Every other Monday	6:30 – 8:30 PM	Small Group (p. 9) West Tampa Every other Tuesday
9:30 – 10:45 AM	Saving Your Marriage Before It Starts (p.14) Ballast Point Campus <i>Begins March 25</i>	7 PM	Small Group (p. 10) South Tampa <i>Single Men</i>	6:30 PM	Small Group (p. 10) Howard and Bayshore Every other Tuesday
9:30 – 10:45 AM	Starting Point (p.8) Davis Islands Campus <i>Start date to be announced</i>	7-9 PM	Daniel: Lives of Integrity, Words of Prophecy (p. 13) Women's Bible Study Ballast Point Campus		
9:30 – 10:45 AM	Resolving Everyday Conflict (p. 12) Davis Islands Campus <i>Beginning February 5</i>	7:30 PM	Serving and Growing Together (p. 12) Single Adults		
11 – 12:15 PM	I Love You More (p. 14) Ballast Point Campus <i>Begins February 19 for 6 weeks</i>				
12:45 - 3:30 PM	Shoreline Membership Marathon Class (p. 8) Davis Islands Campus <i>February 19</i> Ballast Point Campus <i>May 6, October 28</i>				
6:30 – 8:30 PM	Life of Christ (p. 12) Kennedy and West Shore home <i>Beginning February 12</i>				

WEDNESDAY		THURSDAY		FRIDAY	
6 – 7:40 PM	Growing Kids God's Way (p. 14) Ballast Point Campus <i>Beginning February 8</i>	7 AM	Small Group (p. 10) South Tampa <i>Men</i>	11:30 AM – 1 PM	Wild at Heart (p.13) Location TBD <i>Men</i>
6:15 – 7:45 PM	Shoreline Membership Class (p. 8) Ballast Point Campus <i>April 18 and 25 (attend both)</i>	11 AM – 1 PM	Small Group (p. 10) Ballast Point Campus <i>Men</i>		
6:30 – 7:45 PM	The Book of Ruth Ballast Point Campus <i>Led by Pastor Craig in the East Worship Center</i>	6:30 PM	Small Group (p. 10) South Tampa <i>Single Women Beginning February 7</i>		
6:30 – 7:45 PM	Starting Point (p. 8) Ballast Point Campus	6:30 PM	Celebrate Recovery (p. 15)		
6:30 – 7:45 PM	Single Moms (p. 11) Ballast Point Campus	6:30 PM	Divorce Care (p. 16)		
6:30 – 7:45 PM	Wives' Group (p. 13) Ballast Point Campus <i>Beginning March 21</i>	6:30 PM	GriefShare (p. 16)		
		7 PM	Small Group (p. 9) Ballast Point area		



Getting Started

Starting Point

Starting Point groups are conversational environments in which people can explore faith and experience community. Using a 10-week guide along with CDs, individuals explore the grand story and themes of the Bible, and then meet for a group discussion and to ask and answer questions. These groups are great places for people exploring the beliefs of Christianity, those beginning a relationship with Christ and wanting to better understand the story of grace in the Bible, and individuals returning back to church as adults. Workbook and CD cost: \$20. Please sign up in advance. Contact jessica@stfchurch.com with any questions.

Sundays, 9:30-10:45 AM, start date to be announced
Islands Campus, Room 132

Child care available for those who sign up

Wednesdays, 6:30-7:45PM, beginning February 8
BP Campus, Room B208

Led by Jose and Christina DeJesus

Child care available through the Wednesday night program

Shoreline Membership Class

Shoreline connects you to the mission and strategy of STF. These meetings offer you an opportunity to find out more about STF, explore membership opportunities, ask questions, and, if you so desire, get connected. To sign up for the next class, or for more information, email Membership@stfchurch.com, or complete the contact form at www.stfchurch.com/membership. The membership class is offered for two consecutive weeks on Wednesday nights at the Ballast Point Campus or during one “marathon” class on a Sunday afternoon.

The same class is taught at BP and DI, so you can attend a class at either campus, regardless of which campus you regularly attend.

Shoreline Membership Evening Classes (attend both classes for two consecutive weeks)

Wednesdays, 6:15-7:45 PM, BP Campus, Room A201

April 18 and April 25

August 22 and August 29

(Child care provided through Wednesday night program)

Sunday Afternoon “Marathon” Classes (attend only one session)

Sunday, 12:45-3:30 PM

February 19, Islands Campus

May 6, BP Campus

October 28, Islands Campus

(Child care is available with advance reservation. Lunch is provided.)

Small Groups

Get connected with others to “be the church” to one another and to the city throughout the week. Beyond Sunday, God has more for us and desires to work in our lives through authentic relationships, as a spiritual family. In smaller gatherings at various locations throughout the week, group members spend time together to grow in their relationship with Christ and each other through:

- Sharing life and meals, caring for one another, and investing in each other’s lives;
- Prayer and learning from the Bible;
- Living out their faith by serving the needs of people in our city and the world.

Small groups meet for about two semesters (February through December). Throughout the year, the group decides its ongoing schedule for meeting, child care approach if needed, what to study, times for having fun and serving the city together. Contact Groups@stfchurch.com with questions.

- After you sign up at the Connection Fair or online at www.stfchurch.com a group leader will contact you via email about the first group event and address.
- For new groups, the purpose of the first meeting will be to connect, get to know each other, and discuss the plan for the next few months.
- For groups with children welcome, the child-care / baby-sitting plan will be determined during the first meeting. (See STF Policy for Child Care in Groups in the Appendix).
- Please plan to attend a small group for at least the first two months to give it a full try. It often takes that long for people to begin to know and appreciate each other!

The following are new groups or existing groups with room to welcome new people:

Mixed

Anyone is welcome to a mixed group, whether married or single.

Ballast Point Area

Thursdays, 7-8:30 PM

Led by Peter & Maureen Knight

Child-care plan determined by the group

West Tampa (North of Downtown, Seminole Heights area)

Tuesdays, every other week, 6:30-8:30 PM

Led by Jason & Robin Vosler and Barry & Jackie Larson

Child-care plan determined by the group

North Tampa (Carrollwood to Lutz)

Every other Monday, 7-8:30 PM

Led by Boyd & Chrissy Chitwood and Greg & Gwynn McNutt

Child-care plan determined by the group

Brandon (Near I-75 and East Martin Luther King Boulevard)

1st and 3rd Mondays, 6-7:30 PM

Led by Steve & Rachel Holland

Child-care plan determined by the group



Howard and Bayshore
Every other Tuesday, 6:30 PM
Led by Mark & Linda Hamilton
Child-care plan determined by the group

Neighborhood Gatherings

These are one-time gatherings to meet others in the area and determine interest in an ongoing group or gathering.

MacDill AFB Dessert and Coffee
Sunday, February 12, 6 PM
Hosted by the STF MacDill Connecting Team

Open to MacDill AFB individuals only. Sign up if you would like to attend a gathering at the Harbor Bay Welcome Center (a/k/a Community Center) to meet other military families and gauge interest for beginning new small groups meeting on base. The Harbor Bay Welcome Center is at 8414 Fortress Drive, MacDill AFB. Bring your favorite ice cream toppings; ice cream and coffee will be provided. Kids are welcome!

Pinellas / St. Pete Dessert and Coffee
Sunday, February 12, 7-8:30 PM
Hosted by Steve and Darby Musha

Join the group to meet others living “across the bridge” in the St. Pete area and to explore interest in setting an ongoing meeting time for a group/gathering. Kids are welcome!

Men

Single Men (South Tampa)
Mondays, 7 PM, beginning February 6
Led by Matt Vivion and Chris Cerverella

Connect with other single guys for fellowship/activity such as flag football, golf, etc., as well as going through a study together.

Men – Married & Single (Panera Bread on Howard Avenue)
Thursdays, 7 AM, already started
Led by Eric Most and Michael Barna

Connect with other men to deepen in knowing and living out the Bible.

Men – Married & Single (BP Campus)
Thursdays, 11 AM-1 PM, already started
Led by Cid LaNoue and Dave Halterman

Connect with other men for various studies and growing together.

Women

Single Women (South Tampa)
Every other Thursday, 6:30 PM, beginning February 7
Led by Jackie Most and Cassie Hopkins

Connect with other women to grow in relationship with each other and for Bible study.



Single Moms

Wednesdays, 6:30-7:45 PM, BP Campus, Room B207

Led by Catie Whelan

Meet with other single mothers for community, encouragement and Bible study. Children can attend Awana or have child care through the Children's Ministry on Wednesdays. No sign-up is needed; you can show up at anytime.

Semester Growth Groups

Growth groups focus on a particular topic of growth and meet for a certain number of weeks based on the length of the study. These are different from small groups in that the Growth Groups focus on getting equipped in a particular area such as marriage, finances, or another topic and last the length of the study or topic, rather than one year. Please contact Groups@stfchurch.com with any questions.

- After you sign up at the Connection Fair or online at www.stfchurch.com, a group leader will contact you via email about the first group meeting and address.
- For groups with children welcome, a child-care/baby-sitting plan will be determined at the first meeting. (See STF Policy for Child Care in Groups in the Appendix).

Foundations

Life of Christ: Knowing and Following Jesus

Sundays, 6:30-8:30 PM, beginning February 12, Kennedy and West Shore area home

Led by Ben and Anne-Leigh Moe

This group will explore the life of Jesus Christ through a 12-week study in one of the Gospels. It is a great place to get foundations in growing in a relationship with Jesus Christ, and to experience community with others. Through your own study using a study guide, and through group discussion, you can grow in knowing Jesus as He teaches, serves, and transforms those He encounters. Honest questions and discussions about faith are encouraged! This is a good group to consider as a next step for those who have gone through Starting Point. All life stages are welcome. Parents arrange for their own child care.

Missional/Serving

Single-Adult Men & Women – Serving and Growing Together

Mondays, 7:30 PM, beginning February, South Tampa home

Led by Weilin Lin, Nellie Hunter, and Mary Fritz

This group will meet for 10 weeks, alternating weeks between serving the community together one week and gathering for a study the next week called *Hope Lives: A Journey of Restoration*, by Amber Van Schooneveld.

Book cost: \$12

Wise Living

Resolving Everyday Conflict, by Ken Sande and Kevin Johnson

Sundays, 9:30-10:45 AM, beginning February 5, Islands Campus, Room 131

Led by John & Shelby Hladon and Doug & Tabitha Free

Conflict is a normal part of everyday life and of every relationship – family, marriage, friendships, and at work. But do we know how to pursue peacemaking in a loving and humble way that honors God? For most of us, conflict can bring out a “fight” or “flight” response, but God has given us a better way. This eight-week study, which includes a short DVD video, helps you take a look at God’s direction for everyday conflict and gives practical tools that take you beyond resolving conflicts to true, life-changing reconciliation with family, co-workers, and fellow believers. Child care is available for those who sign up.

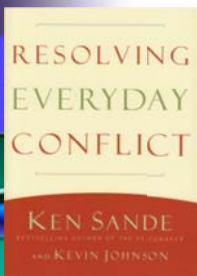

Trading Up – Experiencing Real Financial Freedom – Half-Day Workshop
Saturday, February 11, 9 AM-12 PM, BP Campus Fellowship Hall

Led by Jon Locklear

Do you feel trapped, always dealing with the same money questions and problems? Be a part of our 3-hour workshop, at which we'll examine Randy Alcorn's study: *Trading Up – Experiencing Real Financial Freedom*. You'll learn God's answers to the world's messages about money and how God can use money to train you and use you in exciting ways. You'll also learn five practical steps from Scripture that lead to real financial freedom. Contact jessica@stfchurch.com with any questions.

Men

Wild at Heart: Discovering the Secret of a Man's Soul, by John Eldredge
Fridays, 11:30 AM-1 PM, beginning February 17, location TBD

Led by Dan Giberga

This 12-week men's lunch group will use the "Wild at Heart: Band of Brothers" DVD series. This study throws down the gauntlet: Men are bored; they fear risk; they refuse to pay attention to their deepest desires. It challenges Christian men to return to authentic masculinity without resorting to a "macho man" mentality. Overall, the series points to only one answer for men searching for their true wildness of heart: an ongoing, intimate relationship with God. Beyond Wild at Heart, the final four weeks will cover sexual purity, contrasting God's plan for sex and intimacy in marriage with the world's twisted view of it.

Cost for book and participant's guide: \$20

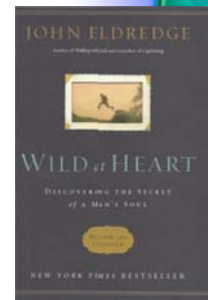

Women

Daniel: Lives of Integrity, Words of Prophecy (All women)

Mondays, 7-9 PM, BP Campus, beginning February 6

Tuesdays 9:30-11:30 AM (child care to age 5 available with reservation prior to the event), BP Campus, beginning February 7

Join us to connect with other women and explore life as Beth Moore provides a personal study experience five days a week plus viewer guides for the group video sessions of this in-depth women's Bible study. *Daniel* is a faith-building study of prophecy and learning how to live with integrity in today's self-absorbed society. The prophet Daniel faced unbelievable pressures to compromise his faith, live in a hostile culture, and confront temptations and threats. Today, believers in Jesus Christ face many of the same trials. This 12-session study begins with a DVD of Beth Moore teaching for approximately 1 hour and 15 minutes, followed by a small-group discussion with other women. Email jennifer@stfchurch.com with questions. Cost for workbook: \$15



Wives' Group

Wednesdays, 6:30 - 7:45 PM, BP Campus, A202, beginning March 21 through May

Led by Lisa Graybill

This group offers community and growth for wives whose husbands aren't involved in a weekly Bible study or group at this time. The study topic will be announced. Child care is available through the Wednesday evening children's program

Marrieds



Premarital: Saving Your Marriage Before It Starts, by Les & Leslie Parrott

Sundays for 8 weeks, 9:30-10:45 AM, BP Campus, Room B207, beginning March 25

This eight-week group is for engaged or almost-engaged couples from either campus. This study aims at equipping couples to prepare for lifelong marriage. Meeting the needs of a generation overwhelmed by divorce odds, relationship experts Les and Leslie Parrott share seven key questions to help couples identify and overcome stumbling blocks to building a healthy, lifelong marriage.

Child care is available through the regular Sunday morning Children's Ministry.

Cost for book, and men's and women's workbook: \$26



I Love You More: How Everyday Problems Can Strengthen Your Marriage, by Les & Leslie Parrott

Sundays for 6 weeks, 11-12:15, BP Campus, Room B207, beginning February 19

Led by Mike and Jodi Merritt

This group will meet to help strengthen marriages and encourage each other in trusting God. Even the best marriages experience problems, and using a DVD-based curriculum, the study includes practical and relevant tools to help couples transform major or mild issues into loving opportunities. Surprisingly, the struggles can become the tipping point for a deeper love between a husband and wife.

Children will be cared for through regular Sunday morning Children's Ministry.

Cost for men's and women's participants guides: \$15

Parents

Child Dedication Class

Sundays for three weeks, 9:40-10:40 AM, BP Campus Children's Ministry Area, Room D100, beginning February 5

Led by Children's Ministry leadership

This three-week group is for parents from either campus. The meetings will provide insight into what Christian parenting can look like, engage the parents in conversation about their goals for their child and about the centrality of faith in their family's life. Parents will gain an understanding of STF's Preschool and Children's Ministry, as well as how the ministry can partner with them as they raise their children.

Classes will be February 5, 12 and 19, culminating with a Child Dedication event for family and friends on February 26, from 4-5 PM, at the BP Campus.

Child care will be provided through regular Sunday morning Children's Ministry.



Growing Kids God's Way: Along the Virtuous Way

for parents of preschoolers to young elementary-age children

Wednesdays for 17 weeks, 6-7:40 PM, BP Campus, Room A200, beginning February 8

Led by Scott and Beth Wiggins

This 17-week study is a comprehensive values-based curriculum that helps parents reach the hearts of their children. The study will offer insights on strengthening the marriage relationship to create a stable and secure family environment, equipping parents to train their children in Christian character and conduct while providing guidance and practical tools for addressing parenting issues. Parents will have heartfelt discussions on the material and watch a video presentation by the authors of the curriculum.

Please contact Cassie@stfchurch.com with any questions.

Child care will be provided through regular Wednesday evening activities.

Healing and Growth

Celebrate Recovery

Thursdays evenings (including all holidays), BP Campus

We all get stuck. It's never fun to be in that muddy place where you know you're just not living the life God intended for you. That's why we have Celebrate Recovery (CR). CR is a Christ-centered recovery program providing biblical help to overcome hurts, habits, or hang-ups. CR is available to anyone who is stuck – with anger, addictions, anxiety, or whatever. The purpose of Celebrate Recovery is to bring freedom through biblically-based principles that lead to God's healing power in our lives. Visit www.crtampa.com with any questions.

The schedule includes:

5:30-6:15 PM **Dinner**

6:30-7:30 PM **Large Group:** CR Praise Team and Band provide worship, followed by either a teaching or a testimony (which alternate)

7:30-8:30 PM **Small Groups:** gender- and issue-specific, along with a newcomer's orientation every Thursday

8:30-9 PM **Coffeehouse:** Time of fellowship and light refreshments for meeting new people

Child care is provided through Celebration Station from 6:15-9 PM.

CR Step Studies

Spring studies to be announced

The Celebrate Recovery step study is the format participants use to work through hurts, habits, and hang-ups. CR's four Participant Guides direct participants on a personal journey through each of the 12 steps and eight recovery principles. Step study groups are gender-specific and are led by men or women who have completed a step study. They last about 9-12 months.



DivorceCare and DivorceCare for Kids

Thursdays, 6:30-8:45 PM, BP Campus, Room A218, beginning February 9

Led by Miranda & Jeff Lessie and Skeeter Thomas

DivorceCare helps you recover from the pain of separation and divorce. A series of seminars and support groups are led by people who understand what you are experiencing. Most importantly, you'll learn how to deal with the pain of the past and look forward to rebuilding your life. This group will meet through mid-April.

Cost for materials: \$20

DivorceCare for Kids (DC4K)

for children ages 5-12 who have parents who are separated or divorced

Thursdays, 6:30-8:45 PM, BP Campus, Children's Ministry area, beginning September 15

Led by the DC4K Team

DC4K is the perfect complement to the DivorceCare program. The DC4K content is synchronized with the DivorceCare material, creating the opportunity for kids and parents to have meaningful conversations about the issues they face. Besides DC4K, there is also child care at the Ballast Point Campus during this time. Contact Lindsey@stfchurch.com with any questions.

Cost for book: \$12

GriefShare

Thursdays, 6:30-8:30 PM, BP Campus, Room 209, start date to be announced

You don't have to go through the grieving process alone. GriefShare is made up of a friendly, caring group of people who will walk alongside you through one of life's most difficult experiences: the death of a loved one. GriefShare seminars and support groups are led by people who understand what you are going through and want to help. You'll gain access to valuable resources to help you recover from your loss and look forward to rebuilding your life.

Contact GriefShare@stfchurch.com with any questions.

Cost for book: \$12

Life-Stage Opportunities and Gatherings

Senior Adults

Monthly Open Door Lunch

Join the senior adults for a monthly lunch and fellowship. People from all ages and stages of life are welcome. Dates and times will be published in The Buzz and Sunday Shoreline. Contact Pastor Tom Sander at Tom@stfchurch.com with any questions.

Valentines Day Lunch

Sunday, February 12, 12:30 PM, Ballast Point Campus

Provided by 97West (Singles ministry)

97West loves serving our seniors every Valentines weekend. The singles go hoping to gain new grandparents while the seniors go hoping to gain new grandchildren. This lunch is a time of loving and serving. It's set up like the open door lunch, but 97West singles make the time extra special. Email Lindsey@stfchurch.com with any questions.

Single Adults

97West, Tuesdays, 7:30 PM, Islands Campus

97West includes single young professionals from around the Tampa Bay area who desire to pursue God in the company of friends. They gather on Tuesday nights for worship, teaching, food, and conversation in a safe, non-threatening environment – but that is just the beginning of what this ministry is about. Participants actively involve themselves in our community and even in other countries through acts of service; they huddle in homes and coffee shops for authentic community; and in general they seek to celebrate life together. This is a ministry *by* singles more than it is a ministry *for* singles. Stop by. Plug in. Make a difference. Contact Lindsey@stfchurch.com with any questions, or visit www.97west.com.

97West Retreat

The group's next retreat will be a camping trip.
When and where: TBD

Monthly Service Projects

January: Feeding the homeless

February: Valentines Lunch for STF seniors



Students and Children

EPIC Student Ministry: Middle and High School Students

Check out www.thestudentwebsite.com for more information about any EPIC gathering, group or event, or contact students@stfchurch.com with any questions.

EPIC Sunday Nights (all students)

6:30-8 PM, DI Campus

Doors open at 6 PM for pre-party games, and the after party ends at 9 PM. This is our “top of the funnel” connection gathering for students, and everyone is welcome! The evening includes engaging in relevant worship led by Steve Holland and our student worship band, a dynamic and biblically relevant message, most often delivered by our Student Pastor Rob Flint, and a time for all students to engage in small groups with their fellow students and adult leaders. This amazing night ends with games, food and fellowship in the GAME ROOM! Join us weekly!!

Sunday Morning Groups (middle and high school students)

Sundays, 11 AM, 2nd floor, BP Campus, beginning January 8

Age- and gender-specific groups are offered and overseen by Steve Holland and are led by adult volunteers, who are following a student curriculum called “LIVE.”

EPIC Home Groups (middle and high school students)

These groups will meet in different homes, at different times each week, to engage in a variety of topics and biblical discussions. The focus will be on growing in Christ through building relational discipleship. A complete list of leaders, locations and meeting times is listed below. Sign up at www.thestudentwebsite.com

Middle School Girls

The Boney's, 2812 Old Bayshore Way 33611, Wednesday, 6:30 PM
Leaders: Anna Boney, Nicole Jones, and Allysa Rees

9th-Grade Girls

The Parsons', 2629 W. Prospect Road 33629, every other Tuesday, 6:30 PM
Leaders: Annette Sullivan and Nicole Scott

10th-Grade Girls

The Schepps', 3510 N. San Miguel St. 33629, Tuesday, 3:10-4:30 PM
Leaders: Jennifer Schepps and Christy Anderson

11th-Grade Girls

The Wertzes', 4319 W Neptune St. 33629, Monday, 8 PM
Leader: Marianne Parsons

12th-Grade Girls

The Wertzes', 4319 W Neptune St. 33629, Monday, 8 PM
Leaders: Monnie Wertz and Rebecca Greelings

Middle School Boys

Wednesday, 6:30 PM
Location and Leader TBD

9th-Grade Boys

The Sheas', 4211 W. Palmira Ave. 33629, Wednesday, 6:30 PM

Leaders: *Brad Shea and Ben McGinley*

10th-Grade Boys

The Stewarts', 4415 San Rafael St. 33629, Monday 4 PM

Leader: *Shea Vosler*

11th-Grade Boys

Your Pie, 2219 S. Dale Mabry Highway 33629, Thursday, 6 PM

Leaders: *Chris Sullivan and John Cooper*

12th-Grade Boys

The Branagans', 3402 W. Barcelona St. 33629, Thursday, 7:21 PM

Leader: *Brian Branagan*

LIFE (middle and high school students)

Wednesdays, 6:30-7:45 PM, 2nd floor, BP Campus, begins February 8

This group is geared to help teenagers with tough life situations, including hurts, habits and hang-ups, using a curriculum called "Life Hurts, God Heals."

EPIC Tutoring (middle and high school students)

Wednesdays, 6:30-7:30 PM, Room B200, BP Campus

This is a free opportunity for students who need a place and time to get extra help with school work from experienced tutors in an encouraging and safe environment. We want to challenge our students to pursue excellence in every area of life — doing all things for the glory of God.

EPIC Serving (high school students)

Each Sunday morning and Wednesday night students have the opportunity to serve in our church community within the Children's Ministry. Please contact Cassie Hopkins at cassie@stfchurch.com for more info.

EPIC Events

Underground Weekend

More information will be online at www.thestudentwebsite.com

SWO Camp

6/10-6/16

\$450

Sign up online at www.thestudentwebsite.com

Brazil Mission Trip

8/9-8/16

\$1,500-\$2,000

Information is online at www.thestudentwebsite.com



Children's Ministry

STF's Children's Ministry partners with parents to build a legacy of faith in the Lord Jesus Christ.

Tide Pool (infants through preschool)

The Tide Pool is a Sunday-morning preschool program for infants through 4-year-olds, which provides warm environments that are rich for giving children a first look at their heavenly Father. In the Tide Pool, our young STF children are full of wonder and excitement about the world around them. That is why the web-based curriculum called "First Look" is used to help babies and preschoolers discover who God is. The strategy teaches three key truths: God made me, God loves me, and Jesus wants to be my friend forever. Each month one of those three basic truths is taught through Bible stories, music and engaging activities. To help reinforce what was taught, parents receive a "Parent Cue" sheet when they pick up their children that gives suggested activity ideas to complete at home.

Pier 3:16 (kindergarten - 5th grade)

On Sunday mornings, kindergarten through 5th-grade groups use a curriculum strategy based upon three basic truths Jesus modeled in Luke 2:52. One core virtue is taught each month using a variety of Bible stories, fun activities, games and small-group discussion. Children take home two tools parents can use to continue the conversation started in church. The "Parent Cue" cards are designed to be used in the natural rhythm of the day: breakfast, drive time, dinner time, or bedtime, as applied from Deuteronomy 6:5-8. The GodTime cards are used four days a week to have devotions with parental guidance or in an older child's own daily time with God. These valuable GodTime cards encourage children to apply what they are learning about God and His character to their daily situations and problems.

Awana (2-year-olds - 6th grade)

The Awana season continues through March 28 on Wednesdays, from 6:05-7:45 PM. Each age group has content specifically geared toward them.

It's never too late to join in and start your children hiding God's Word in their hearts. There are even adult books that correspond with what the children are memorizing if you'd like to grow in your knowledge of His Word and keep pace with what your children know. For more information on Awana, including volunteer opportunities, please contact Karen McClure at karenm@stfchurch.com.

JUMP!

From April 4 through May 30 the children will be JUMPING! – learning to put their faith in motion as they follow the travels of the apostle Paul. JUMP! includes great songs, along with large- and small-group activities. This program will be fun for the children and easy on the family schedules that get so busy as the school year draws to a close.

Appendix

Ballast Point Campus Map

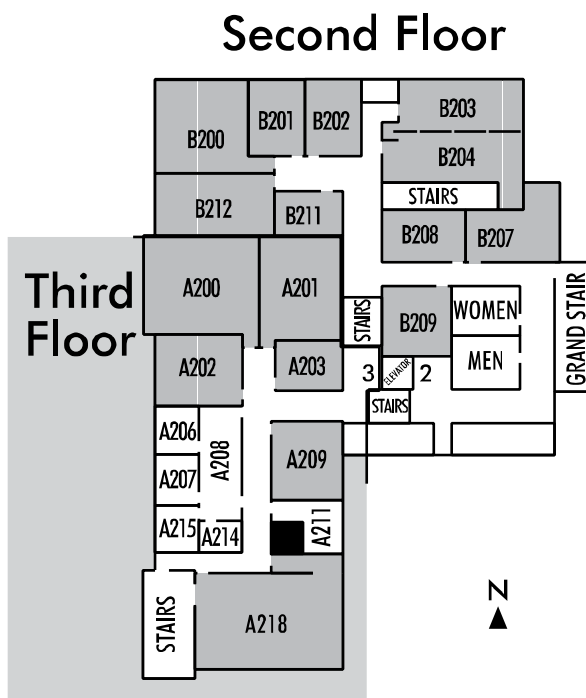
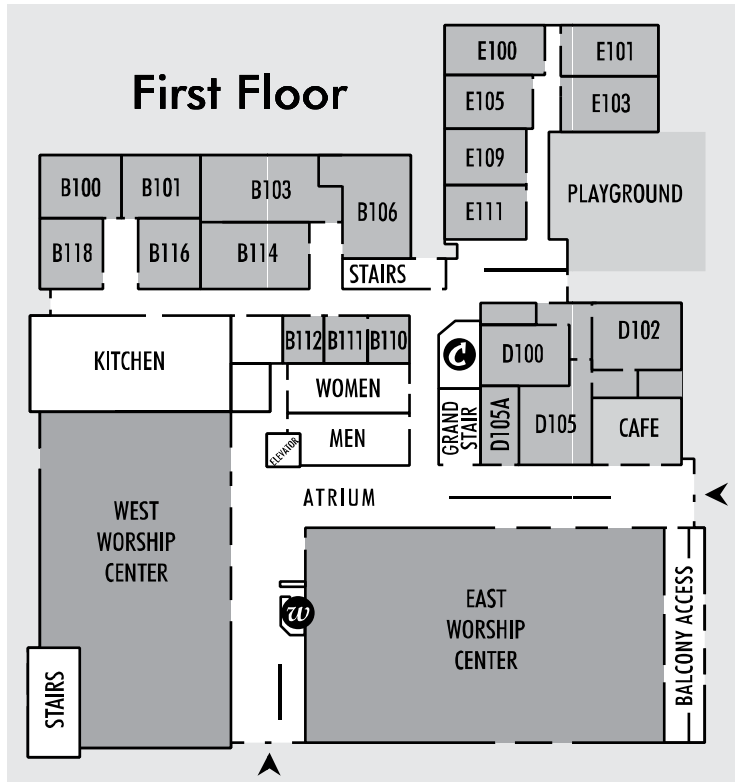



STF Policy for Child Care in Groups

Members of each small group determine their own approach to caring for children during the group time. As a church we recognize that for groups to function effectively there must be a plan for child care. Though possible, it is difficult to concentrate in a group when young children are present. Accordingly, these are our suggestions for how to provide child care while your group is meeting:

Option A – Rotating Child Care Among the Group Members

With this option, the members of the group rotate the child care among themselves. Each parent or two parents take care of the children at a central location, ideally where (or close to where) the group meets) for one week, and then it switches to another parent or single adult the following week. The advantage of this is that it costs nothing, except that each single or couple might miss a week once every 6 weeks or so to serve the kids and the group.

Option B – Paid Baby-Sitter(s)

You can choose to pay a baby sitter (or two, if your group is large) to watch the children at a central location (ideally at or close to where the group meets). Because we are mindful of costs, if needed, the church will contribute \$20 total per night for any group that utilizes paid baby-sitting. That may not cover all the costs, but it will help. For example, in one group, the members add \$5 per family, per meeting, to the \$20 church contribution, to make it an attractive proposition for the baby-sitter(s). If you utilize that option, the group will need to follow the STF Groups Child Care Reimbursement Policies and Procedures.

Option C – Individual Baby-Sitting

Some parents may prefer to arrange their own baby-sitter. If you choose that option, you would be responsible for the costs yourselves, as it would unfortunately be prohibitively expensive for the church to fund.

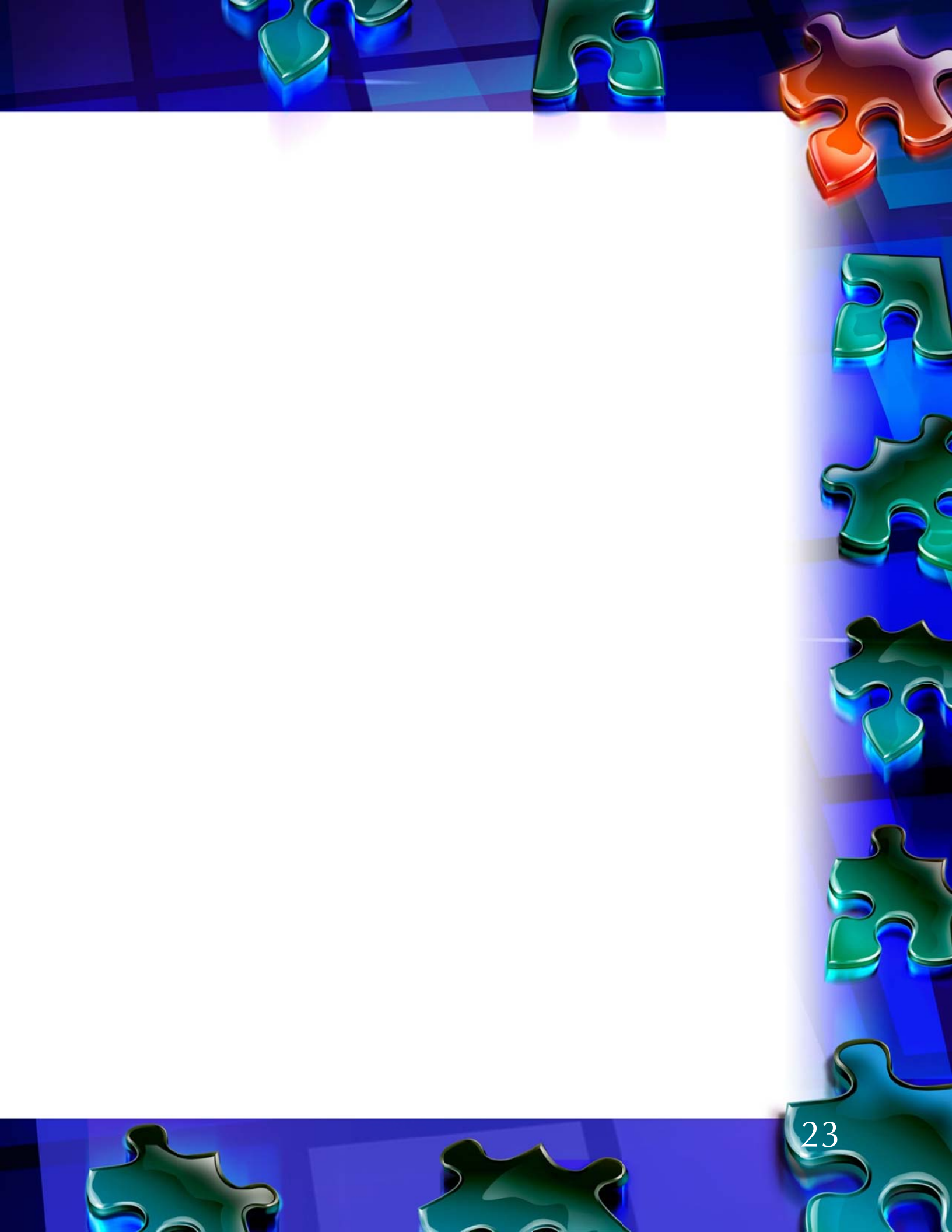



www.stfchurch.com
813-251-1515

ISLANDS CAMPUS

97 Biscayne Ave., Tampa, FL 33606
Sunday Worship 11 AM
Sunday Growth Groups 9:30 AM

BALLAST POINT CAMPUS

5101 Bayshore Blvd., Tampa, FL 33611

Sunday Worship
8 AM — Classic
9:30 AM — Contemporary
11 AM — Contemporary

Sunday Bible Study/Growth Groups
9:30 AM and 11 AM